

Spherical Roller Bearings for Mobile Cement Mixer Gearboxes



The following bearings are designed for use in mobile cement mixer gearboxes. The bearings are mounted onto the main shaft of the gearbox and are offered in three basic designs: PLC 58-6, PLC 59-5, and PLC 59-10, all have a wider outer ring, increasing the self-aligning ability of the bearing. These bearings are produced within ABEC 1 tolerance and have a C0 radial clearance.

The PLC 59-5 has a two-piece brass cage, which allows a higher operating temperature than other plastic cage designs. The brass cage also offers complete compatibility with all synthetic lubricants.

The PLC 59-10 also has a two-piece brass cage and offers all the same design advantages as the PLC 59-5. This bearing also has a high capacity design, which increases the dynamic and static load ratings. Both PLC 59-5 and PLC 59-10 have a two-piece split outer ring, which allows for maximum rollers and a narrower inner ring.

The PLC 58-6 has a polyamide cage, which allows the bearing to be assembled so that the outer ring does not have to be split into two pieces.

Spherical Roller Bearings for Mobile Cement Mixer Gearboxes

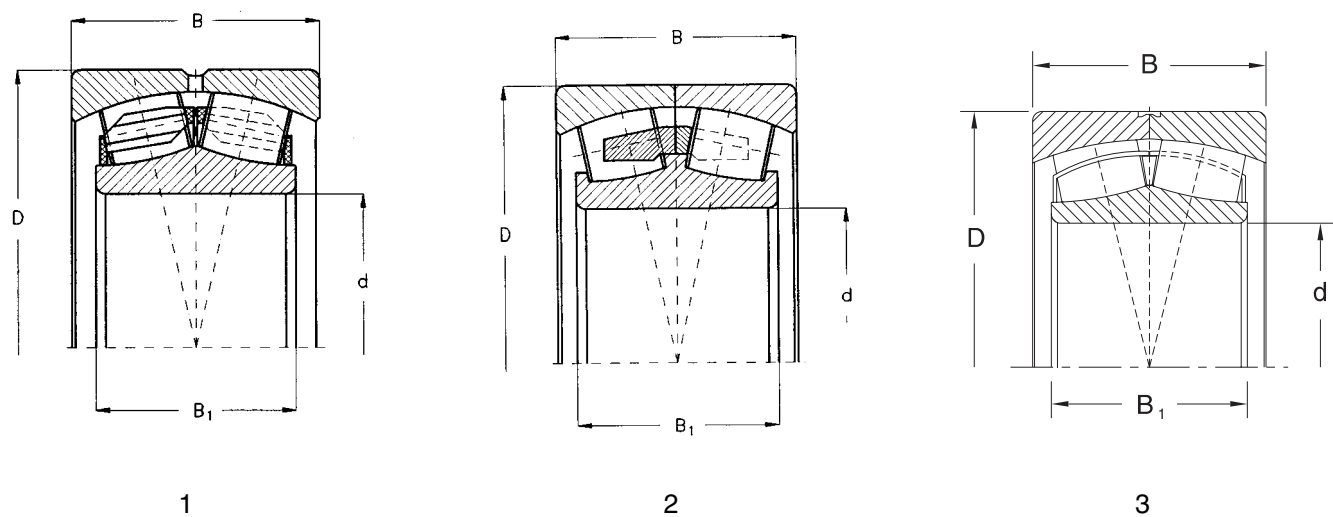

Designation	Dimension				Basic Load Rating			
	d	D	B	B ₁	Dynamic C _r	Static C _{or}	Dynamic C _r	Static C _{or}
	mm				kN	kN	lbs.	lbs.
PLC 58-6	100	150	62	50	310	550	69.691	123.645
PLC 59-5	100	180	82	69	480	710	107.908	159.614
PLC 59-10	110	180	82	69	501	849	112.629	190.863

Limiting Speed for		Weight	Coefficients				Figure
Grease	Oil		e	Y_1	Y_2	Y_0	
rpm		kg					
2.000	2.600	3.70	0.30	2.30	3.30	2.20	1
1.400	1.800	10.30	0.42	1.67	2.42	1.60	2
1.400	1.700	8.00	0.37	1.80	2.70	1.80	3

J