

Overview: SL - Journal Bearings

Übersicht: SL - Zapfenlager

Typ	Design/ Bauform	Dimension/ Abmessung									Load rating per bearing/ Tragzahl pro Lagerreihe		Radial clearance/ Radiale Lagerluft
		d	d ₁	D	S ₂	L	A	B	B ₂	B ₁	C(kN)	C ₀ (kN)	(µm)
SL1116-01	1	5.4	M3	11		16	24.2	8.2			0.64	0.23	2-13
SL1116-02	1	5.4		11		16	25.25	9.25			0.64	0.23	2-13
SL1116-07	1	5.4	M3	11			24.2	8.2			0.64	0.23	4-14
SL1116-09	1	5.4		11		16	25.25	9.25	2	5	0.64	0.23	2-13
SL1520-02.2D	1	7.5		15		20	39.5	19.5			1.46	0.74	2-13
SL1520-03.2D	1	7.5		15		20	28	8			1.46	0.74	2-13
SL1520-07.2D	2	7.5	M6	15	18	20	39.5				1.46	0.74	8-23
SL1520-08.2D	2	7.5	M6	15	15	20					1.46	0.74	8-23
SL1520-15.2D	1	7.5	M5	15		20	28	8			1.46	0.74	2-13
SL1625	1	7.5	M5	16		25	28	3			1.46	0.74	2-13
SL1639-03	1	7.85		15.86		39	69.65	29.15			1.46	0.74	8-23
SL1921-00.2D	1	9		19		21	35.5	14.5			2.78	1.04	2-13
SL1921-02.2D	1	9		19		21	39.5	18.5			2.78	1.04	2-13
SL1921-05.2D	1	9		19		21	39.5	18.5	4.5	6	2.75	1.04	2-13
SL1921-19.2D	1	9		19		21	35.5	14.5	3.5	6	2.78	1.04	2-13
SL1921-20.2D	1	9		19		21	31.5	10.5	2	6	2.78	1.04	2-13
SL1922-00.2D	1	9		19		22	34	12			2.78	1.04	2-13
SL1922-02.2D	1	9		19		22	42	20	4.5	6	2.78	1.04	2-13
SL1930-01.2D	1	9		19		29.7	44.85	15.15			2.78	1.04	2-13
SL1943-06	1	8		19		42.5	73.3	30.8			1.90	0.71	7-17
SL2544-02	1	8		25.15		44	73.8	29.8			1.90	0.71	7-17

Design/Bauform 1

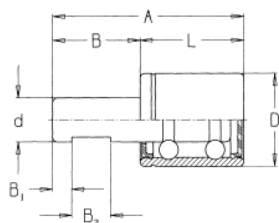

Design/Bauform 2

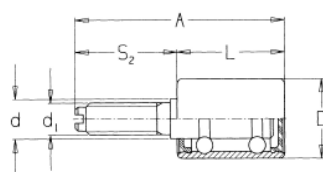

Oerlikon Heberlein Temco GmbH

Fuldaer Str. 19 D-97762 Hammelburg

T: +49 (0) 9732/87-0 F: +49 (0) 9732/87-310

<http://www.temco.de> E-Mail: sales@temco.de